

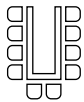

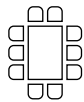
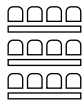
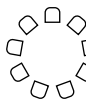

The room Barockzimmer is located on the second floor of the castle and is 31 sqm big. It features an oriel, about 2.5 m x 2.5 m big. The arrangement of the seating is flexible.

Category	Floor space	Ceiling high	Length/Width
S	31 sqm	2.8 m	6.2 m x 5.0 m

### Capacity

				
U-shape	Boardroom style	Classroom style	Round table	Theatre style
<b>8</b>	<b>8</b>	<b>8</b>	<b>10</b>	<b>15</b>

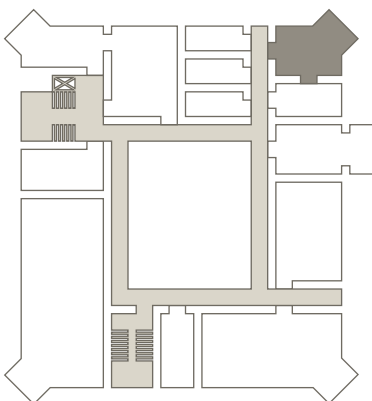

### Equipment

#### Internet

- WLAN/LAN

#### Facilitation

- 1 presentation kit
- 1 quality flipchart
- 1 quality pinboard

#### And...

- Dial extension -934 for immediate support



As well as notepad and pen at the desk for each participant



The room Klausur 4 is located on the first floor of the castle and is 30 sqm big. It features an oriel, about 2.5 m x 2.5 m big. The arrangement of the seating is flexible.

Category	Floor space	Ceiling high	Length/Width
S	30 sqm	3.2m	6.1 m x 4.8 m

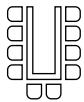
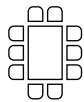
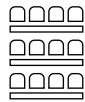
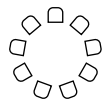
### Capacity

				
U-shape	Boardroom style	Classroom style	Round table	Theatre style
<b>8</b>	<b>8</b>	<b>8</b>	<b>10</b>	<b>15</b>

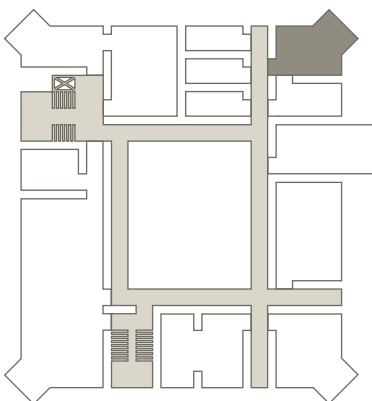

### Equipment

#### Internet

- WLAN/LAN

#### Facilitation

- 1 presentation kit
- 1 quality flipchart
- 1 quality pinboard

#### And...

- Dial extension -934 for immediate support



As well as notepad and pen at the desk for each participant



The room Klausur 6 is located on the second floor of the castle and is 27 sqm big. The arrangement of the seating is flexible.

Category	Floor space	Ceiling high	Length/Width
S	27 sqm	2.8 m	6.7 m x 4.1 m

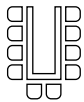
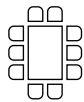
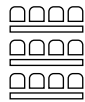
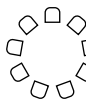
### Capacity

				
U-shape	Boardroom style	Classroom style	Round table	Theatre style
<b>6</b>	<b>6</b>	<b>6</b>	<b>6</b>	<b>10</b>

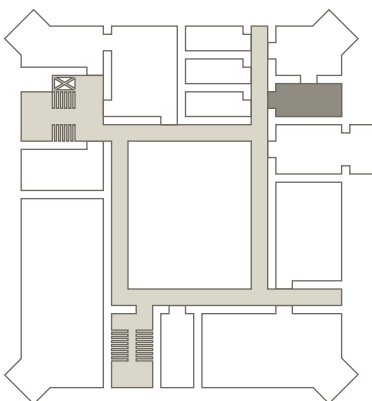

### Equipment

#### Internet

- WLAN/LAN

#### Facilitation

- 1 presentation kit
- 1 quality flipchart
- 1 quality pinboard

#### And...

- Dial extension -934 for immediate support

As well as notepad and pen at the desk for each participant

## Breakout Room 1



2024 06 05



The Breakout Room 1 is located on the second floor of the Gutshof and is 26 sqm big. The arrangement of the seating is flexible.

Category	Floor space	Ceiling high	Length/Width
S	26 sqm	2.4 m	8.2 m x 3.2 m

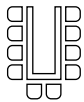
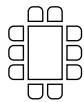
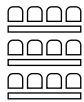
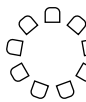
### Capacity

				
U-shape	Boardroom style	Classroom style	Round table	Theatre style
-	8	-	8	-

### Equipment

#### Internet

- WLAN/LAN

#### Facilitation

- 1 presentation kit
- 1 quality flipchart
- 1 quality pinboard

#### And...

- Dial extension -934 for immediate support

As well as notepad and pen at the desk for each participant

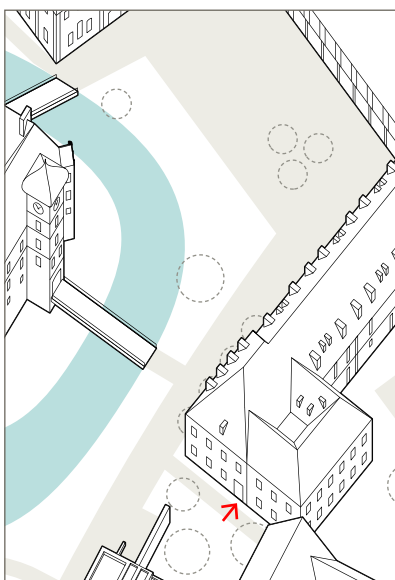





The room Klausur 5 is located on the first floor of the castle and is 24 sqm big. The arrangement of the seating is flexible.

Category	Floor space	Ceiling high	Length/Width
S	24 sqm	3.2m	6.2m x 3.8m

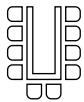
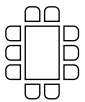
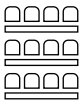
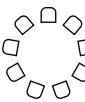
### Capacity

				
U-shape	Boardroom style	Classroom style	Round table	Theatre style
6	6	6	6	10

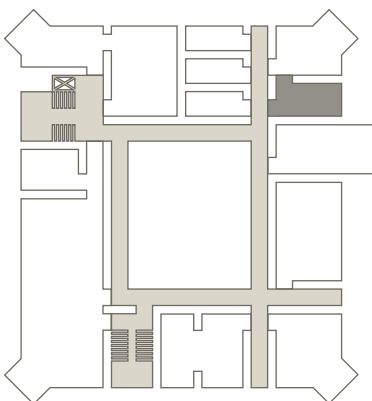

### Equipment

#### Internet

- WLAN/LAN

#### Facilitation

- 1 presentation kit
- 1 quality flipchart
- 1 quality pinboard

#### And...

- Dial extension -934 for immediate support

As well as notepad and pen at the desk for each participant

## Durchblick



2024 06 05



The room Durchblick is located on the ground floor of the Altes Försterhaus and is 23 sqm big. The seating arrangement is permanent.

Category	Floor space	Ceiling high	Length/Width
S	23 sqm	2.9m	6.1 m x 3.8 m

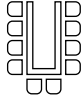
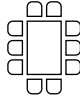
### Capacity

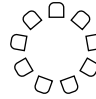
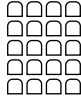
				
U-shape	Boardroom style	Classroom style	Round table	Theatre style
-	8	-	-	-

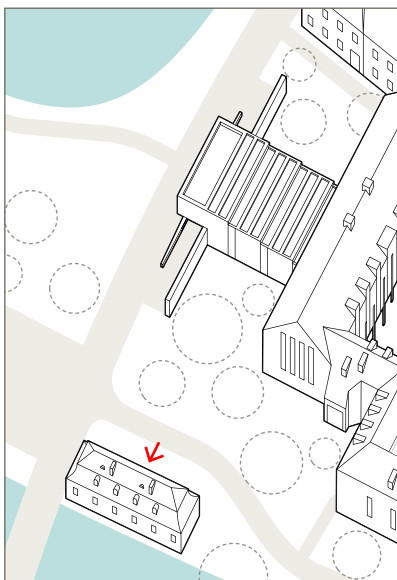

### Equipment

#### Internet

- WLAN

#### Facilitation

- 1 presentation kit
- 1 quality flipchart
- 1 quality pinboard

#### And...

- Dial extension -934 for immediate support

As well as notepad and pen at the desk for each participant

## Breakout Room 2



2024 06 05



The Breakout Room 2 is located on the second floor of the Gutshof and is 22 sqm big. The arrangement of the seating is flexible.

Category	Floor space	Ceiling height	Length/Width
S	22 sqm	2.4 m	5.7 m x 3.8 m

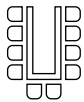
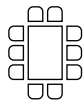
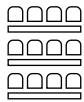
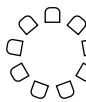
### Capacity

				
U-shape	Boardroom style	Classroom style	Round table	Theatre style
-	8	-	8	-

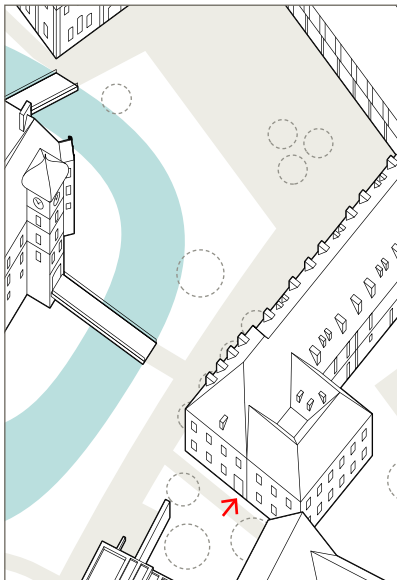

### Equipment

#### Internet

- WLAN/LAN

#### Facilitation

- 1 presentation kit
- 1 quality flipchart
- 1 quality pinboard

#### And...

- Dial extension -934 for immediate support

As well as notepad and pen at the desk for each participant

## Breakout Room 3

2024 06 05



The Breakout Room 3 is located on the second floor of the Gutshof and is 18 sqm big. The arrangement of the seating is flexible.

Category	Floor space	Ceiling height	Length/Width
S	18 sqm	2.4 m	4.8 m x 3.8 m

### Capacity

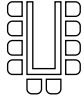
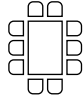
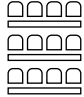
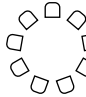
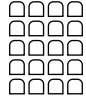
				
U-shape	Boardroom style	Classroom style	Round table	Theatre style
-	8	-	8	-

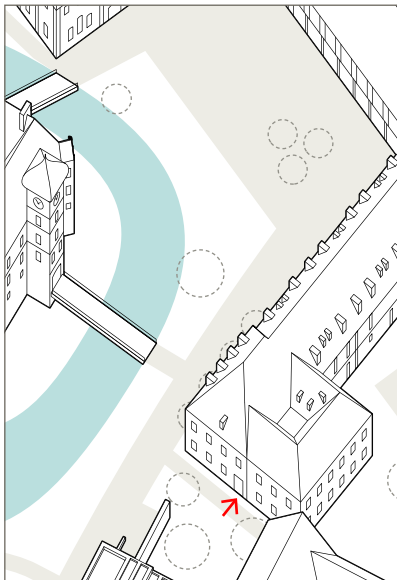

### Equipment

#### Internet

- WLAN/LAN

#### Facilitation

- 1 presentation kit
- 1 quality flipchart
- 1 quality pinboard

#### And...

- Dial extension -934 for immediate support

As well as notepad and pen at the desk for each participant